



What

Next generation deck fill

- Fits every vessel with 1.5" fill hose
- Easy to install
- Modern low profile styling

Boat builders have a new choice

- Reliable availability
- Engineered and designed for long life
- EPA/CARB compliant



Why Switch

Universal Plug & Play

- Works with all fuel systems
- Backwards compatible
- Fits 13/16" and 15/16" nozzles

Easy One Hole Installation

- Lower labor costs to install
- Patent pending

Value Add Features

- Marked hose stop location
- Hose clamp guidance

Best Vacuum Performance

- Always under 0.5kPa
- Less engine fuel line restriction

Best PRV Performance

- 15% Less pressure on fuel tank
- Lower daily pressure cycles
- Safer for tank joints

Rigorously Validated and Tested

- ABYC H24 Compliant
- Durability tested
- Each valve is 100% tested

Expert Technical Support

- Fuel System Architect on call
- 12 Marine Fuel Patents

NEW

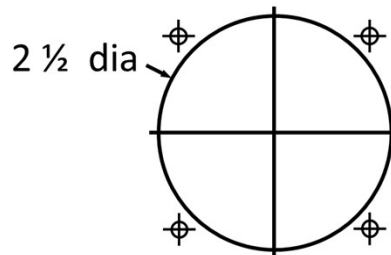

OLD

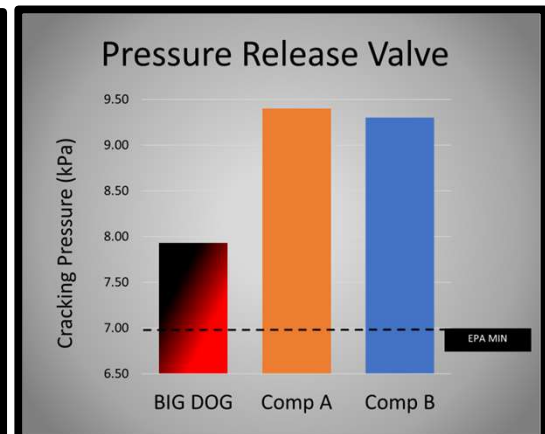
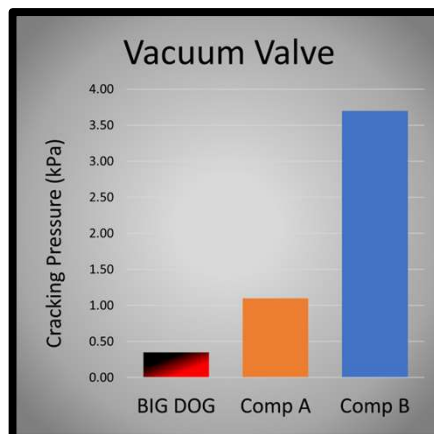
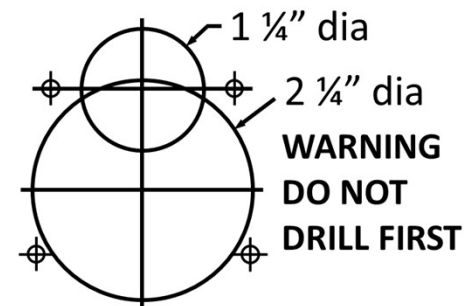



Four Bodies



Three Covers



Part Numbers

Part Number	Liquid Type*	System Architecture	Body Style	Cover Style
999DFCCSB1	Gasoline	Carbon Canister	Straight	Black
999DFCCAB1	Gasoline	Carbon Canister	Angled	Black
999DFCCSZ1	Gasoline	Carbon Canister	Straight	Chrome
999DFCCAZ1	Gasoline	Carbon Canister	Angled	Chrome
999DFCCSS1	Gasoline	Carbon Canister	Straight	Stainless Steel
999DFCCAS1	Gasoline	Carbon Canister	Angled	Stainless Steel
999DFPVSB1	Gasoline	Pressure Relief	Straight	Black
999DFPVAB1	Gasoline	Pressure Relief	Angled	Black
999DFPVSZ1	Gasoline	Pressure Relief	Straight	Chrome
999DFPVAZ1	Gasoline	Pressure Relief	Angled	Chrome
999DFPVSS1	Gasoline	Pressure Relief	Straight	Stainless Steel
999DFPVAS1	Gasoline	Pressure Relief	Angled	Stainless Steel

*Water, Waste and Diesel also available